

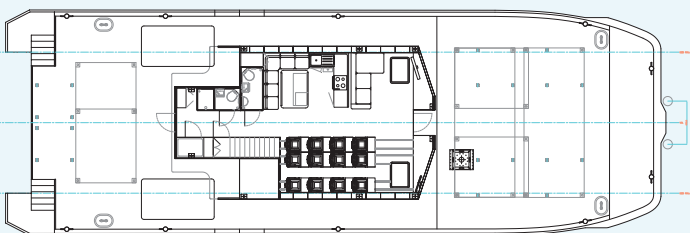

## 26M DNV-GL CLASS OESV SPECIFICATION

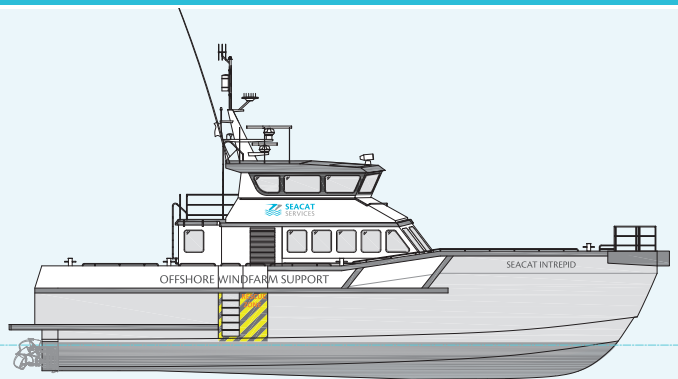

### GENERAL

**Builder:** South Boats Isle of Wight Ltd

**Design:** South Catamaran 26M

**Capacity:** 12 pax, 2/3 crew

**Construction:** Aluminium

**Length Overall:** 26.77m

**Max Beam:** 9.12m

**Draft:** 1.45m

**GRT:** 108 tonnes

**Certification:** DNV-GL  $\times$ 1A1 HSLC R1  
Windfarm Service 1 and Category 1,  
150 NM from safe haven.  
MLC Compliant.

## STATISTICS

FUEL:	25,500 Litres
FRESH WATER:	1500 Litres (with option for desalinator at 275 l/ph)
WASTE WATER:	1500 Litres
SPRINT:	29 Knots
SERVICE SPEED:	26 Knots
CARGO:	20 Tonnes Total; 15 Tonnes Fwd, 5 Tonnes Aft
FWD DECK:	62m <sup>2</sup>
AFT DECK:	44m <sup>2</sup>

## DECK EQUIPMENT

Fuel transfer system, pressure washer, crew access system capable, TMP 900XL Crane, 2 x 20ft or 2 x 10ft container mounts forward and 1 x 16ft or 1 x 10ft aft, multiple tie down points.

## WELFARE

Modular interior - configurable to clients requirements, including; crash tested suspension seats, settee and crew mess area, luggage and spares areas, 2 crew cabins, 2 toilets, shower, air conditioning, heating, cooker/oven, microwave/combo oven, hot water boiler, coffee machine, fridge, washing machine, tumble dryer.

## ENTERTAINMENT

FM Radio, MP3 capability, 3 x LCD TV, KVH Tracvision satellite TV, games console, DVD player, wireless 3G internet, high speed satellite internet (VSAT).

## MAIN ENGINES

MAKE:	MTU
TYPE:	2 x 12V2000 M72
MAX POWER:	2160 kw (2900hp)
MAX RPM:	2250

## GEARBOXES

MAKE:	ZF
MODEL:	3050 Series 2.037:1

## WATER JETS

MAKE:	Rolls Royce
MODEL:	56A3

## GENERATOR

MAKE:	ONAN
MODEL:	MDKBV
SPEED:	1500 RPM
OUTPUT:	19.5 kw
BACKUP:	6 kw secondary generator

## ELECTRONIC EQUIPMENT

CONTROL SYSTEM: Rolls Royce vector (ROCS) control system with 100% redundancy.

MAIN RADAR: Furuno 2117BB-6.5-24v Radar System  
6.5ft 12Kw Open Array

SECOND RADAR: Furuno 2117BB-4-24v Radar System  
4ft 12Kw Open Array

ECDIS 2 x Furuno FEA 2107-BB

DISPLAYS: 5 x 19" Screen (2 x Touch Screen)  
Furuno DFF1 Network Sounder  
12 x CCTV Cameras

NAVTEX: Furuno NX700B Navtex

GPS: Furuno GP150 GPS

ANEMOMETER: Furuno RD33 c/w Airmar Wind Speed

SPEED LOG: Walker 7070 Electromagnetic Speed Log

DSC VHF: 2 x Sailor RT5022 Class A DSC VHF

INMARSAT A2: Sailor RT5000 MF/HF SSB Radio Telephone

AIS: Furuno FA150 Class A AIS Transceiver

HEADING: Furuno SC50 Satellite Compass

BROADBAND: Globesurfer 3G Wireless Internet

SATCOM B/BAND: KVH TracPhone V3 VSAT

AIRBAND RADIO: Icom F6062 UHF

HAILER: Phontech 3100 System  
FWD & AFT Talkback  
Port and Stbd Rescue Zone Area Talkback  
Passenger Saloon Talkback

SAR EQUIPMENT: Seamarshall SAR Finder  
2 x Jotron SART20 TRON Sart  
Jotron TRON 40GPS/FB5 EPIRB  
Jotron TRON 45SX EPIRB  
2 x Jotron TRON VHF Hand Held Radios  
Flir Thermal Imaging/Low Light Camera  
Fibrelight MOB Recovery System  
SB sling MOB Recovery System