

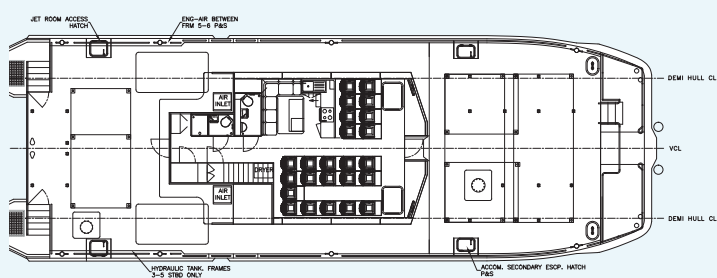

26M BV CLASS OESV SPECIFICATION 24 INDUSTRIAL PERSONNEL

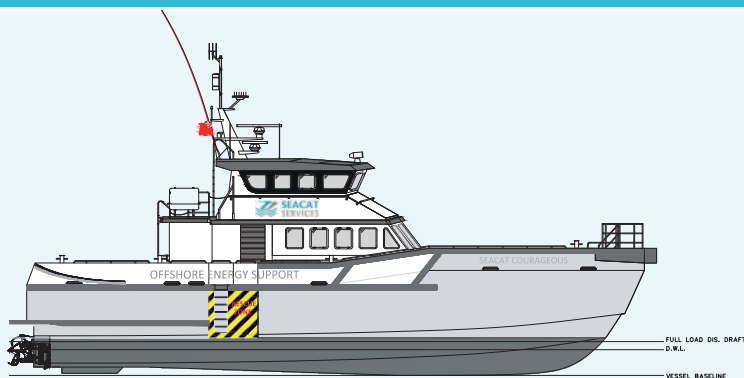

GENERAL

Builder: South Boats Isle of Wight Ltd

Design: South Catamaran 26M

Capacity: 24 Industrial Personnel, 3 Crew

Construction: Aluminium

Length Overall: 26.77m

Max Beam: 9.12m

Draft: 1.45m

GRT: 117.14 tonnes

Certification: 1 HULL MACH Wind farms service ship High Speed Craft; sea area 3 and Category 1, 150 NM from safe haven. MLC Compliant. HS-OSC

STATISTICS

FUEL:	25,500 Litres
FRESH WATER:	1500 Litres
WASTE WATER:	1500 Litres
SPRINT:	26 Knots
SERVICE SPEED:	24 Knots
CARGO:	20 Tonnes Total; 15 Tonnes Fwd, 5 Tonnes Aft
FWD DECK:	62m ²
AFT DECK:	44m ²

DECK EQUIPMENT

Fuel transfer system, pressure washer, crew access system capable, TMP 900XL Crane, 2 x 20ft or 2 x 10ft container mounts forward and 1 x 16ft or 1 x 10ft aft, multiple tie down points.

WELFARE

Modular interior - configurable to clients requirements, including: crash tested suspension seats with 4 point seat belts, settee and crew mess area, luggage and spares areas, 2 crew cabins, 2 toilets, shower, air conditioning, heating, cooker/oven, microwave/combo oven, hot water boiler, coffee machine, fridge, washing machine, tumble dryer.

ENTERTAINMENT

FM Radio, MP3 capability, 3 x LCD TV, KVH Tracvision satellite TV, games console, DVD player, wireless 3G internet, high speed satellite internet (VSAT).

MAIN ENGINES

MAKE:	MTU
TYPE:	2 x 12V2000 M72
MAX POWER:	2160 kw (2900hp)
MAX RPM:	2250

GEARBOXES

MAKE:	ZF
MODEL:	3050 Series 2.037:1

WATER JETS

MAKE:	Rolls Royce
MODEL:	56A3

GENERATOR

MAKE:	ONAN
MODEL:	MDKBV
SPEED:	1500 RPM
OUTPUT:	19.5 kw
BACKUP:	6 kw secondary generator

ELECTRONIC EQUIPMENT

CONTROL SYSTEM: Rolls Royce vector (ROCS) control system with 100% redundancy.

MAIN RADAR: Furuno 2117BB-6.5-24v Radar System
6.5ft 12Kw Open Array

SECOND RADAR: Furuno 2117BB-4-24v Radar System
4ft 12Kw Open Array

ECDIS 2 x Furuno FEA 2107-BB

DISPLAYS: 5 x 19" Screen (2 x Touch Screen)
Furuno DFF1 Network Sounder
12 x CCTV Cameras

NAVTEX: Furuno NX700B Navtex

GPS: Furuno GP150 GPS

ANEMOMETER: Furuno RD33 c/w Airmar Wind Speed

SPEED LOG: Walker 7070 Electromagnetic Speed Log

DSC VHF: 2 x Sailor RT5022 Class A DSC VHF

INMARSAT A2: Sailor RT5000 MF/HF SSB Radio Telephone

AIS: Furuno FA150 Class A AIS Transceiver

HEADING: Furuno SC50 Satellite Compass

BROADBAND: Wifi

SATCOM B/BAND: Intellion V60 VSAT

AIRBAND RADIO: Icom F6062 UHF

HAILER: Phontech 3100 System
FWD & AFT Talkback
Port and Stbd Rescue Zone Area Talkback
Passenger Saloon Talkback

SAR EQUIPMENT: Seamarshall SAR Finder
2 x Jotron SART20 TRON Sart
Jotron TRON 40GPS/FB5 EPIRB
Jotron TRON 45SX EPIRB
2 x Jotron TRON VHF Hand Held Radios
Flir Thermal Imaging/Low Light Camera
Fibreight MOB Recovery System
SB sling MOB Recovery System

VMMS: ReyGar BareFLEET monitoring system